

Use only as directed.

Use one 0,4 ml tube per cat weighing over 1,0 kg and up to 4 kg.

Use one 0,8 ml tube per cat weighing over 4 kg.

For more than 8,0 kg, use the appropriate combination of tubes.

Hold the applicator tube in an upright position. Twist and pull cap off the tube. Turn the cap around and place the other end of the cap back on the tube. Twist cap to break the seal, then remove the cap from the tube.

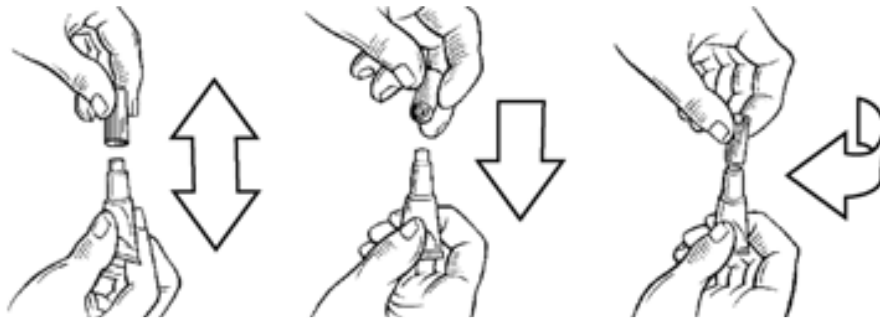

For easy application, the animal should be standing. Part the hair on the cat's neck at the base of the skull until the skin is visible. Place the tip of the tube on the skin and squeeze the tube firmly several times to empty its contents directly onto the skin as a single spot. Application at the base of the skull will minimise the opportunity for the cat to lick the product. Apply only to undamaged skin. Do not get this product in your pet's eyes or mouth.

