

Use only as directed.

**Dosage and directions for use:** Use only as directed.  
Use one 0,4 ml tube per dog weighing over 1,0 kg and up to 4,0 kg.  
Use one 1,0 ml tube per dog weighing over 4,0 kg and up to 10 kg.  
Use one 2,5 ml tube per dog weighing over 10 kg and up to 25 kg.  
Use one 4,0 ml tube per dog weighing over 25 kg and up to 40 kg.  
Dogs weighing over 40 kg should be treated with the appropriate combination of tubes.

Hold the applicator tube in an upright position. Pull cap off the tube. Turn the cap around and place the other end of the cap back on the tube. Twist cap to break the seal, then remove the cap from the tube (See diagram below.)

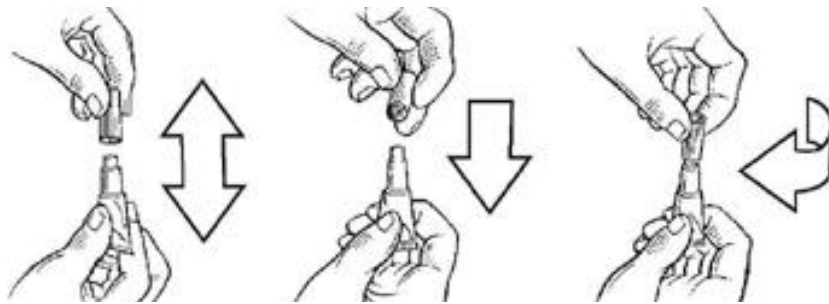

For easy application, the animal should be standing. Part the hair between the shoulder blades until the skin is visible. Place the tip of the tube on the skin and squeeze out the tube several times to empty its contents directly onto the skin as a single spot. For dogs weighing 25 kg and over, the product should be applied evenly to 3-4 spots on the top of the back from the shoulder to the base of the tail. Apply to undamaged skin only. Do not get this product in your pet's eyes or mouth.

